

- KEY**
- █ Existing / Revoked No Vehicles Except Cycles ✓
 - █ Existing / Revoked No Waiting at Any Time
 - █ Existing / Revoked Disabled Parking
 - █ Existing Taxi Bay
 - █ Existing Disabled Parking

This map is based on Ordnance Survey material with the permission of the Controller of Her Majesty's Stationery Office Crown Copyright. Unauthorised reproduction infringes Crown Copyright and may lead to prosecution or civil proceedings. BATH AND NORTH EAST SOMERSET COUNCIL Licence No. 100023334

DATE	FEB 2011	DRAWN BY	ADC	APPROVED BY	SRC
SCALE	1:1000	CHECKED	DST		
DATE	02/11	CLARITY CHECKS		ADC	DST
REV.	A	REVISIONS		DRWL.	CHKD.
					APPROV.

Bath & North East Somerset Council
 KELVIN PACKER
 SERVICE MANAGER - HIGHWAYS AND PARKING
 ENVIRONMENTAL SERVICES

DESIGN GROUP

PROPOSED EXTENSION TO
 NO VEHICLES EXCEPT CYCLES
 EXISTING AND REVOKED TRAFFIC ORDERS

DRAWING No. TR240013/TRO/20 REV. A

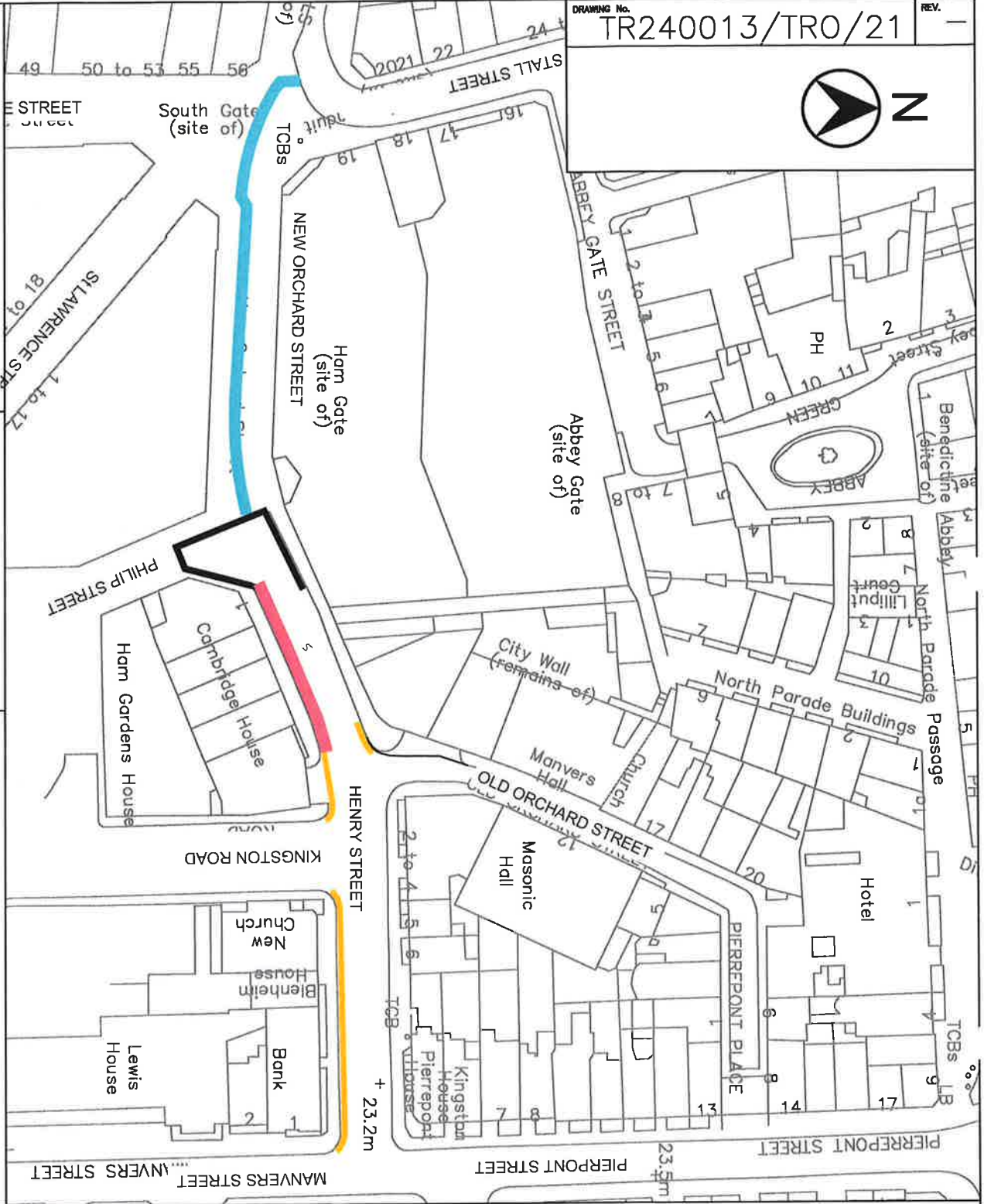

- KEY**
- Proposed No Waiting at Any Time
 - Proposed No Vehicles Except Cycles
 - Proposed No Waiting at Any Time and No Loading at Any Time
 - Proposed Disabled Parking

This map is based on Ordnance Survey material with the permission of the Controller of Her Majesty's Stationery Office Crown Copyright. Unauthorised reproduction infringes Crown Copyright and may lead to prosecution or civil proceedings. BATH AND NORTH EAST SOMERSET COUNCIL Licence No. 100023334

REV.	DATE	REVISIONS	DRAWN	CHD.	APPROV.

DATE	FEB 2011	DRAWN BY	ADC	APPROVED BY	SRG	
SCALE	1:1000	CHECKED	DST			
CLIENT REF:						
DRAWING No.	TR240013/TRO/21				REV.	-

Bath & North East Somerset Council

KELVIN PACKER
SERVICE MANAGER - HIGHWAYS AND PARKING
ENVIRONMENTAL SERVICES

DESIGN GROUP

PRODUCED BY

SCHEME TITLE
NEW ORCHARD STREET BATH

DRAWING TITLE
PROPOSED EXTENSION TO NO VEHICLES EXCEPT CYCLES PROPOSED PERMANENT TRAFFIC ORDERS